



Staff Lounge Addendum

ADA Option • Update, October 2009

Possible Floor Plan and Equipment Layout

The following elevation and floor plan illustrate possible equipment configurations for a typical 400sf Staff Lounge.

Elevation

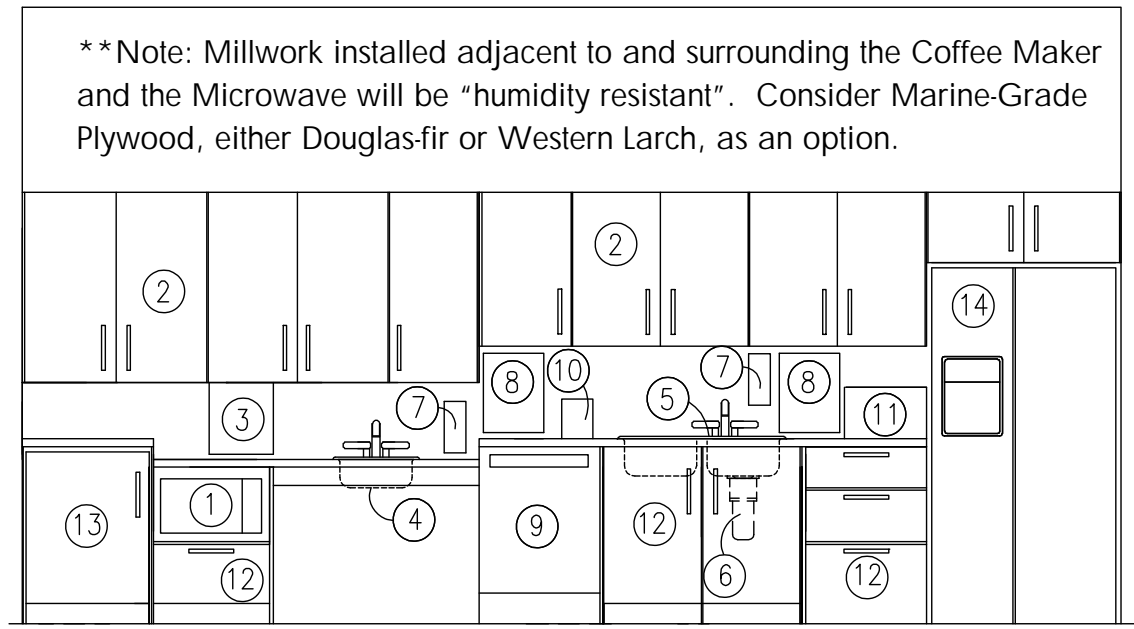

Equipment List

- | | |
|---|--|
| ① Microwave (undercounter Optional ADA) | ⑪ Toaster Oven (Countertop) Optional |
| ② Wall Cabinets | ⑫ Base/Floor Cabinets |
| ③ Coffee Maker (Mounted under Cabinet) | ⑬ Undercounter Refrigerator (Optional ADA) |
| ④ ADA Compliant One Compartment Sink | ⑭ Refrigerator/Freezer with Water/Ice Dispenser |
| ⑤ Two Compartment Sink | ⑮ 26" Flat Screen TV / DVD } Optional - User to Decide |
| ⑥ Garbage Disposal | ⑯ TV Wall Mount } Blocking, Power, & Data |
| ⑦ Soap Dispenser (two) (ACCD provided) | ⑰ Ceiling Mounted Projector } required always. |
| ⑧ Paper Towel Dispenser (two) (ACCD provided) | ⑱ Smart Board (Team Board) |
| ⑨ Dishwasher | ⑲ Tackable Space (8' Linear Feet) |
| ⑩ Toaster | |

(ADA Options) Staff Lounge Addendum

Possible Floor Plan and Equipment Layout, October 2009 Updates

Floor Plan

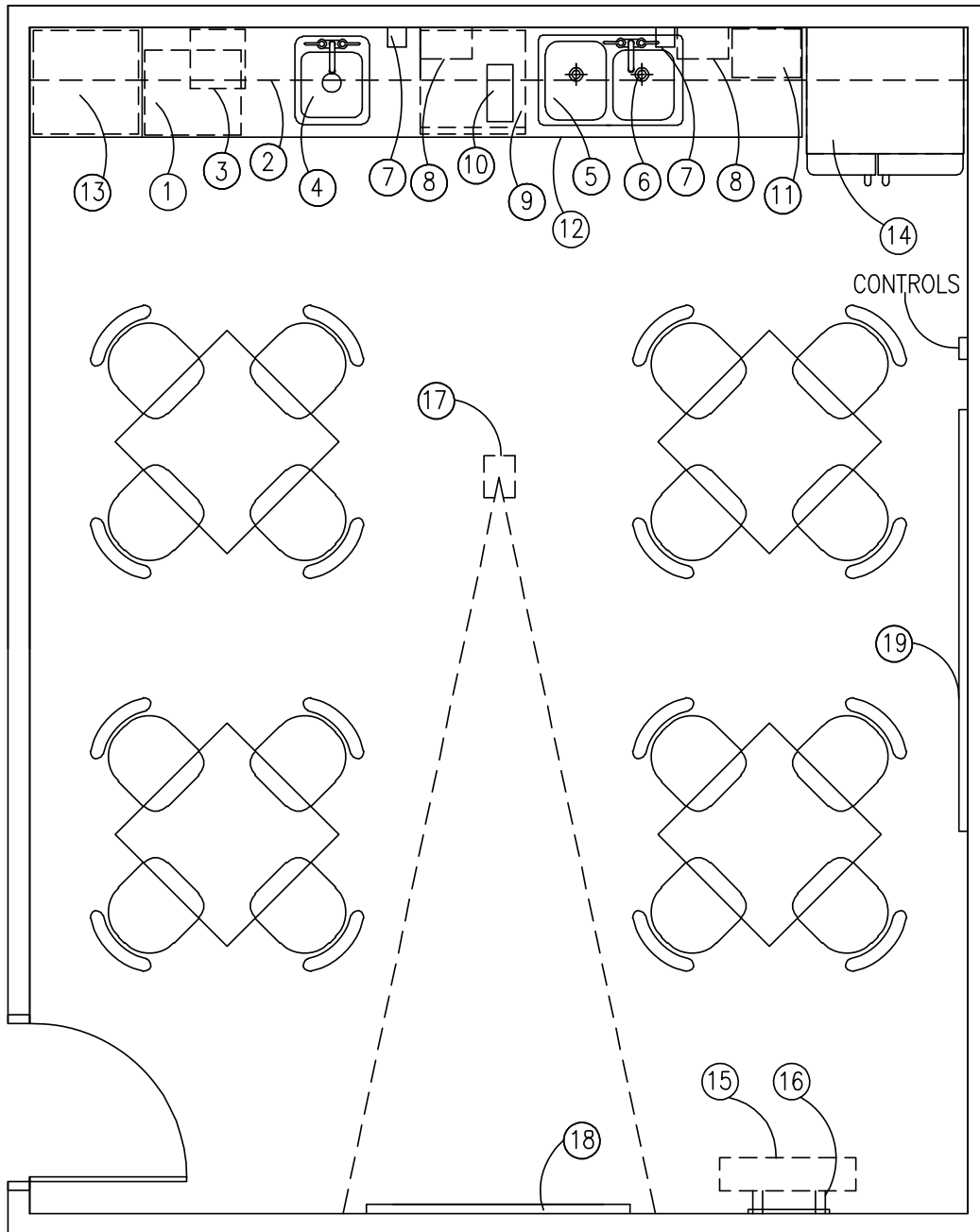

Staff Lounge
400 net sq.ft.

(ADA Options) Staff Lounge Addendum

October 2009 Updates

Please note the Spec Sheets for the items listed below have been removed and replaced due to discontinuation of the products. Also note some of the replacement items have a BB after the product number indicating black or an SS after the product number indicating stainless steel. All the major replacement appliances are available in either finish as indicated below. All appliances chosen shall have the same finish and coordinate per the individual breakroom.

Updates:

Microwave:	Previous Model # JE1590SH Replacement Model # PEB1590DMBB (Black) Or Model # PEB1590SMSS (Stainless Steel)
Coffee Maker:	Previous Model # ODC425 Series Replacement Model # SDC740B
Dishwasher:	Previous Model # GLDA696MSS Replacement Model # GLDA690PBB (Black) Or Model # GLDA696PSS (Stainless Steel)
Toast-R-Oven:	Previous Model # TRO700 Series Replacement Model # TRO700B
Refrigerator:	Previous Model # PSS29NST Replacement Model # GSHF9NGYBB (Black) Or Model # GSHS9NGYSS (Stainless Steel)
Toaster:	Previous Model # 169137 (GE) Replacement Model # T4030 (Black & Decker)

Attachment I:
Staff Lounge Cut Sheets



Select Category

[Where To Buy](#) | [en español](#)

- [Home](#)
- [Products](#)
- [Service & Support](#)
- [Rebates & Promotions](#)
- [Kitchen Design Center](#)
- [Recipes & Cooking Communities](#)
- [Explore GE Brands](#)

GEAppliances.com Home > Products > Countertop Microwave Ovens > PEB1590DMBB

[Email This Page](#) [Printer-Friendly Page](#)

GE Profile™ 1.5 Cu. Ft. Countertop Convection/Microwave Oven

Model #: PEB1590DMBB



To magnify, move your mouse over the image above.

LITERATURE & MANUALS

- [Quick Specs](#)
- [Use and Care Manual](#)
- [CAD Download](#)

All documents are PDF files. You will need [Adobe Acrobat® Reader®](#) to view.

PARTS & ACCESSORIES



GE Profile™ Deluxe 30" Trim Kit
JX1530DMBB



GE Profile™ Deluxe 27" Trim Kit
JX1527DMBB

To **purchase** related parts & accessories:
Call 1-866-775-4557
Shop online at the [Parts & Accessories Store](#)
[Locate a dealer near you](#)

[Est. Retail Price](#)

\$509

[Available Rebates](#)

Where to Buy

APPROXIMATE DIMENSIONS (WxHxD)
22 5/8 in x 14 7/8 in x 19 7/8 in [See full dimensions](#)

1.5 cu. ft. capacity
1000 Watts (IEC-705 test procedure)

Convenience cooking controls
One-touch cooking controls make operation fast and easy

Control Dial
Allows quick, easy adjustment of time and temperature settings

Sensor cooking controls
Automatically adjusts time and power for delicious cooking results

Optional built-in trim kit
Achieve a custom appearance and built-in convenience with a sleek, matching trim kit

Removable pedestal rack
Pedestal cooking rack allows for multi-level cooking simultaneously, allowing you to cook large quantities of your family's favorites

SEE COMPLETE PRODUCT DETAILS

- [Additional Colors](#)
- [Capacity](#)
- [Features](#)
- [Appearance](#)
- [Weights & Dimensions](#)
- [Power Ratings](#)
- [Warranty](#)

ADDITIONAL COLORS

- Black on Black**
PEB1590DMBB
\$509 ERP
- White on White**
PEB1590DMWW
\$509 ERP
- Stainless Steel**
PEB1590SMSS
\$559 ERP

- CAPACITY [hide capacity](#)

Total Capacity (cubic feet)	1.5 cu ft
Unit Capacity	Family-Size

- FEATURES [hide features](#)

Turntable	Glass Recessed
Turntable Size (in.)	12-3/4
Microwave Oven Interior	Stainless Steel
Instant On Controls	Yes
Scrolling Display with Help	Yes
Time Cook	I & II
Microwave Sensor Cooking Controls	Beverage (Instant-On) Cook Popcorn (Instant-On) Reheat
Cooking Technology	Microwave/Convection
Timer (On/Off)	No / Yes
Rack Type	Removable Oven Rack - Pedestal
Microwave Oven Control Features	Child Lock Add 30 Seconds (Instant-On) Cooking Complete Reminder

SERVICE & SUPPORT

- [Microwave Oven Troubleshooting & Service](#)
- [Register Your Appliance](#)
- [Extended Warranties](#)
- [Appliance Donation Center](#)
- [Contact Us](#)

	Display On/Off Auto & Time Defrost Clock
Combination Cooking Controls	Combination Cook
Microwave Watts (IEC-705)	1000 W
Electronic Digital Display with Clock	Yes
Time Preference	Time Input Button
Cooking System	Turntable
Electronic Scrolling Digital Display	Yes
Sound Volume Control	Yes
Express Cook	Instant-On
Power Levels	10

- APPEARANCE

[hide appearance](#)

Case Color	Black
Color Appearance	Black on Black
Built-In Capability	Optional 27" Built-In Kit JX1527DMBB Optional 30" Built-In Kit JX1530DMBB
Door Color	Black

- WEIGHTS & DIMENSIONS

[hide weights & dimensions](#)

Approximate Shipping Weight	57 lb
Net Weight (lbs.)	52 lb
Overall Height	14 7/8 in
Overall Width	22 5/8 in
Overall Depth	19 7/8 in
Cavity (W x H x D)	15-1/4 x 10-7/8 x 15-1/4

- POWER / RATINGS

[hide power / ratings](#)

Electrical Input - 120V Amperage	13.0
Frequency (MHz)	2450
Electrical Input - 120V Watts	1500

- ACCESSORIES

[hide accessories](#)

Cookbook	Yes
----------	-----

- WARRANTY

[hide warranty](#)

Warranty Notes	For models produced on or after January 1, 2006 See written warranty for full details
Labor Warranty	Limited 1-year entire appliance
Parts Warranty	Limited 1-year entire appliance Limited 5-year magnetron tube

Have more questions? Please contact 1-800-626-2005.

Where to Buy

Sign up for our e-Newsletter:

Enter E-Mail Address



[View current issue](#)

LITERATURE & MANUALS

- [Quick Specs](#)
- [Use and Care Manual](#)
- [CAD Download](#)

 All documents are PDF files. You will need [Adobe Acrobat® Reader®](#) to view.

PARTS & ACCESSORIES



**GE Profile™ Deluxe
30" Trim Kit**
JX1530DMBB



**GE Profile™ Deluxe
27" Trim Kit**
JX1527DMBB

To **purchase** related parts & accessories:
Call 1-866-775-4557
Shop online at the [Parts & Accessories Store](#)
[Locate a dealer near you](#)

SERVICE & SUPPORT

- [Microwave Oven Troubleshooting & Service](#)
- [Appliance Donation Center](#)
- [Register Your Appliance](#)
- [Contact Us](#)
- [Extended Warranties](#)

Cooking Technology	Microwave/Convection
Timer (On/Off)	No / Yes
Rack Type	Removable Oven Rack - Pedestal
Microwave Oven Control Features	Child Lock Add 30 Seconds (Instant-On) Cooking Complete Reminder Display On/Off Auto & Time Defrost Clock
Combination Cooking Controls	Combination Cook
Microwave Watts (IEC-705)	1000 W
Electronic Digital Display with Clock	Yes
Time Preference	Time Input Button
Cooking System	Turntable
Electronic Scrolling Digital Display	Yes
Sound Volume Control	Yes
Express Cook	Instant-On
Power Levels	10

- APPEARANCE

[hide appearance](#)

Case Color	Black
Color Appearance	Black on Black
Built-In Capability	Optional 27" Built-In Kit JX1527DMBB Optional 30" Built-In Kit JX1530DMBB
Door Color	Black

- WEIGHTS & DIMENSIONS

[hide weights & dimensions](#)

Approximate Shipping Weight	57 lb
Net Weight (lbs.)	52 lb
Overall Height	14 7/8 in
Overall Width	22 5/8 in
Overall Depth	19 7/8 in
Cavity (W x H x D)	15-1/4 x 10-7/8 x 15-1/4

- POWER / RATINGS

[hide power / ratings](#)

Electrical Input - 120V Amperage	13.0
Frequency (MHz)	2450
Electrical Input - 120V Watts	1500

- ACCESSORIES

[hide accessories](#)

Cookbook	Yes
----------	-----

- WARRANTY

[hide warranty](#)

Warranty Notes	For models produced on or after January 1, 2006 See written warranty for full details
Labor Warranty	Limited 1-year entire appliance
Parts Warranty	Limited 1-year entire appliance Limited 5-year magnetron tube

Have more questions? Please contact 1-800-626-2005.

Where to Buy

Sign up for our e-Newsletter:

Enter E-Mail Address

[View current issue](#)

PEB1590DM

GE Profile™ 1.5 Cu. Ft. Countertop Convection/Microwave Oven

Dimensions and Installation Information (in inches)

Exterior Dimensions (in inches)	
W x H x D	22-5/8 x 14-7/8 x 19-7/8

Accessory Trim Kits	"Z"	Trim Kits	Max Height
30" Deluxe	29-3/4"	JX1530DMWW/BB	21"
27" Deluxe	26-7/8"	JX1527DMWW/BB	21"

Note: 120V, 60-cycle, grounded power receptacle location optional on back within cabinet opening.

Installation Information: This information is not intended to be used for installing unit described. Before installing, consult installation instructions packed with product/kit for current dimensional data.

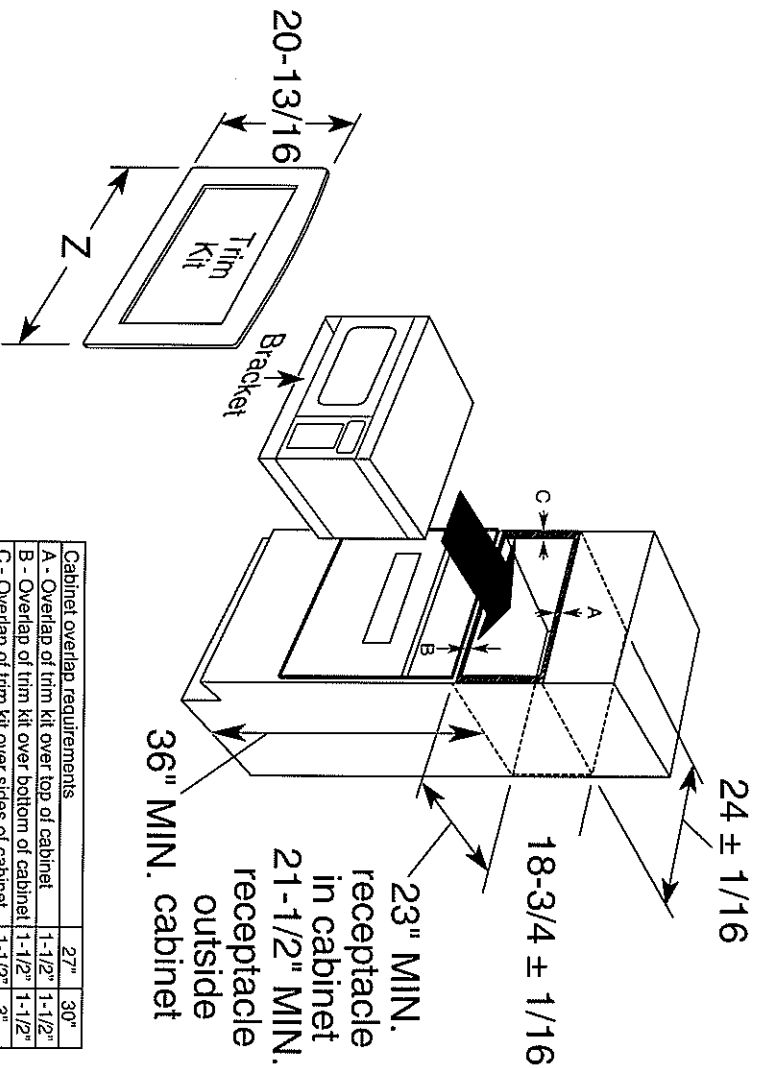

For answers to your Monogram,® GE Profile,™ or GE® appliance questions, visit our website at ge.com or call GE Answer Center® service, 800.626.2000.



imagination at work



PEB1590DM

GE Profile™ 1.5 Cu. Ft. Countertop Convection/Microwave Oven

Features and Benefits

- 1.5 Cu. Ft. Capacity (IEC-705 test procedure)
- Convection Cooking Controls - Produces flavorful and beautifully browned results
- Control Dial - Allows quick, easy adjustment of time and temperature settings
- Sensor Cooking Controls - Automatically adjust the time and power for exceptional cooking results
- Optional Trim Kit - Offers a built-in appearance of a countertop model
- Removable Pedestal Rack - Pedestal cooking rack allows for multi-level cooking simultaneously, allowing you to cook large quantities of your family's favorites
- Turntable - Continually rotates food to ensure even cooking
- Auto and Time Defrost - Automatically defrosts for a specified amount of time
- Two-Line Bilingual Scrolling Display - Provides helpful cooking tips and oven-use instructions in easy-to-read English or Spanish
- Model PEB1590DMWW - White on white
- Model PEB1590DMCC - Bisque on bisque
- Model PEB1590DMBB - Black on black

For answers to your Monogram,® GE Profile™ or GE® appliance questions, visit our website at ge.com or call GE Answer Center® service, 800.626.2000.

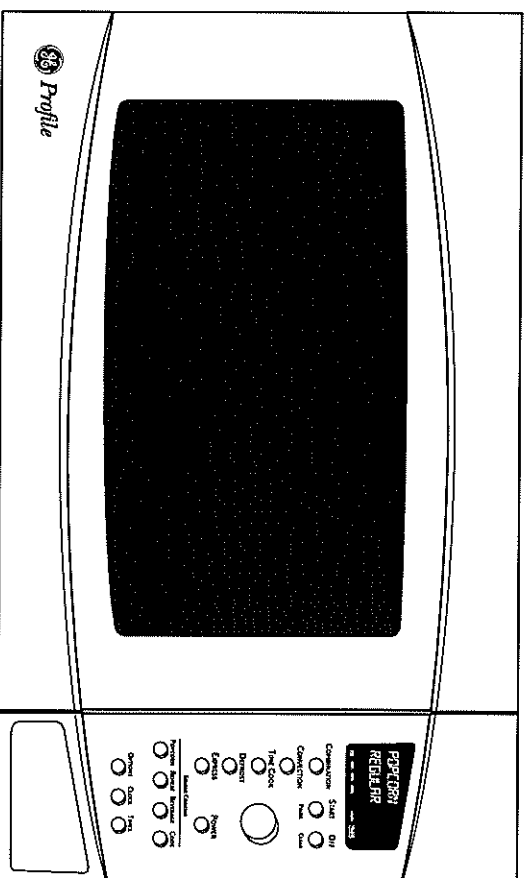

imagination at work





Home

Search: Go Email Address: Subscribe for email updates Go

- [Home](#)
- [Products](#)
- [Recipes](#)
- [Customer Care](#)
- [Where to Buy](#)

Products

- Coffee & Tea
- Food Preparation
- Cooking
- Irons
- SpaceMaker™ Products

Recipes

- Appetizers
- Desserts
- Drinks
- Entrees
- Sauces, Dips & Dressings
- Sides Dishes
- Soups & Stews

Now In: [Products](#) → [SpaceMaker™ Products](#) → [12-Cup Coffeemaker](#)



12-Cup Coffeemaker
SDC740B

Regain Counter Space in Your Home!

Enjoy hot, fresh coffee at the touch of a button without taking up so much room on your counters with a SpaceMaker™ Coffeemaker! With step-by-step instructions and pre-sized mounting template, installation is easy – and save even more room by powering 2 SpaceMaker™ appliances in 1 outlet with our new Save-A-Plug™ feature.

Space-Saving

- Free countertops of appliance clutter
- Save-A-Plug™ outlet
- No storage needed

Easy Installation

- Step-by-step mounting instructions
- Pre-sized mounting template





Simplified Programming

- Programmable clock
- Auto brew
- Easy-access angled control panel

[View larger image](#)

[Previous Product](#) [Next Product](#)

Related Products

			
Brew 'n Go® Personal	SmartBrew Plus®	5-Cup Coffeemaker	Cordless Kettle

ELKAY® SPECIFICATIONS

Lustertone® Single Bowl Sink Models LRAD and LRADQ Series – A.D.A. Compliant

GENERAL

Highest quality sink seamlessly formed of #18 gauge, type 304 (18-8) nickel bearing stainless steel. Self-rimming.

DESIGN FEATURES

LRAD(Q) Bowl Depth: 5-1/2", 6" or 6-1/2".

Coved Corners: 1-3/4" vertical and horizontal radius.

Bowl and Faucet Deck Recess: 3/16" below outside edge of sink.

Finish: Exposed surfaces are hand blended to a lustrous high-lighted satin finish.

Underside: Fully undercoated to dampen sound and prevent condensation.

OTHER

Drain Opening: 3-1/2" (see back for locations).

NOTE: Unless otherwise specified, models with one, two, three or OS4 faucet hole option are furnished with 3 faucet holes as shown; models with choice of one, two, three, four or five faucet hole option are furnished with 4 faucet holes standard.

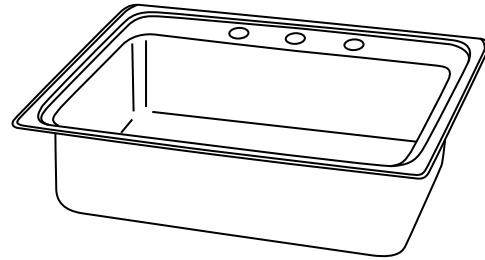

Model LRAD(Q)2521653

SINK DIMENSIONS (INCHES)*

U-Channel Model Number	Quick-Clip® Model Number	Overall		Inside Bowl			Cutout in Countertop (1 1/2" Radius Corners)		No. of 1 1/2" Dia. Faucet Holes 4" Center	3 1/2" Drain Opening (see back for details)	Minimum Cabinet Size	Ship. Wt. Lbs.
		L	W	L	W	D	L	W				
		A	B	C	D	E	L	W				
LRAD1316	LRADQ1316	13	16	10	10	**	12 3/8	15 3/8	1, 2, MR2 or 3	Centered	18	9 1/2
LRAD1517	LRADQ1517	15	17 1/2	12	12	**	14 3/8	16 7/8	1, 2, MR2 or 3	Centered	18	9 3/4
LRAD1522	LRADQ1522	15	22	11 1/2	16	**	14 3/8	21 3/8	1, 2, MR2 or 3	Off-Centered Rear	18	12
LRAD1716	LRADQ1716	17	16	14	10	**	16 3/8	15 3/8	1, 2, MR2, 3 or OS4	Centered	21	8 1/2
LRAD1720	LRADQ1720	17	20	14	14	**	16 3/8	19 3/8	1, 2, MR2, 3 or OS4	Off-Centered Rear	21	12
LRAD1722	LRADQ1722	17	22	13 1/2	16	**	16 3/8	21 3/8	1, 2, MR2, 3 or OS4	Off-Centered Rear	21	13
LRAD1918	LRADQ1918	19	18	16	11 1/2	**	18 3/8	17 3/8	1, 2, MR2, 3 or OS4	Off-Centered Rear	24	10 1/2
LRAD1918L	LRADQ1918L	19	18	16	11 1/2	**	18 3/8	17 3/8	1, 2, MR2, 3 or OS4	Off-Centered Left	24	10 1/2
LRAD1918R	LRADQ1918R	19	18	16	11 1/2	**	18 3/8	17 3/8	1, 2, MR2, 3 or OS4	Off-Centered Right	24	10 1/2
LRAD1919	LRADQ1919	19 1/2	19	16	13 1/2	**	18 7/8	18 3/8	1, 2, MR2, 3 or OS4	Off-Centered Rear	24	13
LRAD2022	LRADQ2022	19 1/2	22	16	16	**	18 7/8	21 3/8	1, 2, MR2, 3 or OS4	Off-Centered Rear	24	14 1/2
LRAD2219	LRADQ2219	22	19 1/2	18	14	**	21 3/8	18 7/8	1, 2, MR2, 3, 4 or 5	Off-Centered Rear	27	13
LRAD2219L	LRADQ2219L	22	19 1/2	18	14	**	21 3/8	18 7/8	1, 2, MR2, 3, 4 or 5	Off-Centered Left	27	13
LRAD2219R	LRADQ2219R	22	19 1/2	18	14	**	21 3/8	18 7/8	1, 2, MR2, 3, 4 or 5	Off-Centered Right	27	13
LRAD2222	LRADQ2222	22	22	19	16	**	21 3/8	21 3/8	1, 2, MR2, 3, 4 or 5	Off-Centered Rear	27	14
LRAD2521	LRADQ2521	25	21 1/4	21	15 3/4	**	24 3/8	20 5/8	1, 2, MR2, 3, 4 or 5	Off-Centered Rear	30	15
LRAD2521L	LRADQ2521L	25	21 1/4	21	15 3/4	**	24 3/8	20 5/8	1, 2, MR2, 3, 4 or 5	Off-Centered Left	30	15
LRAD2521R	LRADQ2521R	25	21 1/4	21	15 3/4	**	24 3/8	20 5/8	1, 2, MR2, 3, 4 or 5	Off-Centered Right	30	15
LRAD3122	LRADQ3122	31	22	28	16	**	30 3/8	21 3/8	1, 2, MR2, 3, 4 or 5	Off-Centered Rear	36	19

*Length is left to right. Width is front to back.

**Available in 5 1/2", 6" and 6 1/2" depths. Please consult your sales representative for other depths or modifications.

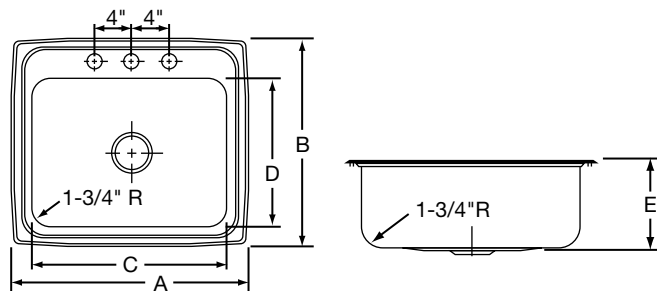

THIS PRODUCT, AS CONSTRUCTED IS SUBJECT TO INTERPRETATION OF A.D.A. REQUIREMENTS. THE UNOBSTRUCTED KNEE SPACE REQUIRED TO SATISFY A.D.A. STANDARDS MAY NOT BE DESIRABLE.

ALL DIMENSIONS IN INCHES, TO CONVERT TO MILLIMETERS MULTIPLY BY 25.4.

In keeping with our policy of continuing product improvement, Elkay reserves the right to change product specifications without notice.

This specification describes an Elkay product with design, quality and functional benefits to the user. When making a comparison of other producers' offerings, be certain these features are not overlooked.

DRAIN OPENING LOCATIONS

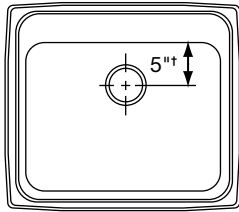

±4-1/2" for LRAD(Q)1522
 Off-Centered Rear

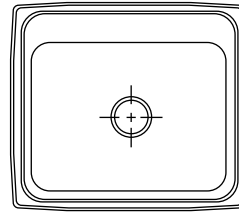

Centered

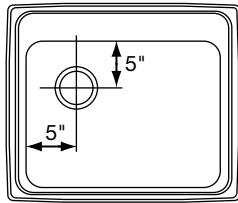

Off-Centered Left

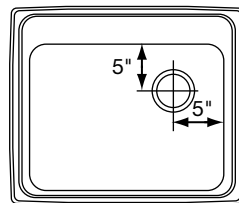

Off-Centered Right

HOLE DRILLING CONFIGURATIONS

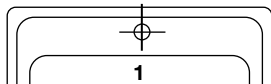

1

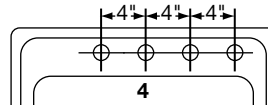

4

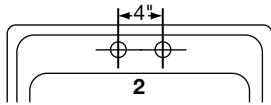

2

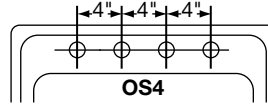

OS4

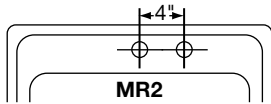

MR2

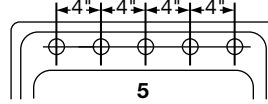

5

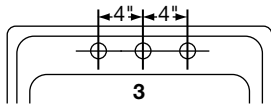

3

Quick-Clip® Mounting System

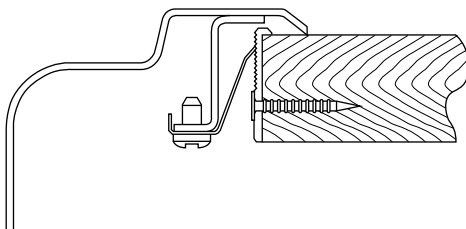

U-Channel Type Mounting System

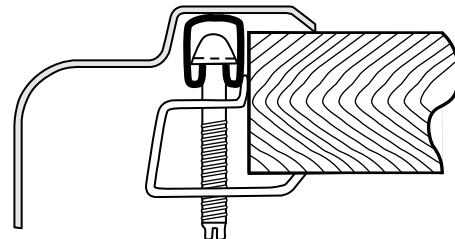

FEATURED MODEL

501-109 7-1/4" & 7-1/4" bowl depths

FEATURES

- 20 gauge, 304 series stainless steel
- 18/8 chrome/nickel content
- Long-lasting, easy-to-clean, satin finish
- Rear drain placement
- Straight bowl sides with 1-1/2" cutout corner radius

OPTIONAL ACCESSORIES

Sink Grids: 221-034 (Formerly 501-915)
 221-035 (Formerly 501-916)
 Colander: 215-651

WARRANTY

Blanco America's BLANCOSPEX™ Series sinks feature a 25-year "NO HASSLE" LIMITED WARRANTY to be free of all manufacturing defects under normal use. See our complete warranty for details.

While Blanco America endeavors to provide accurate information, all dimensions are nominal, cannot be guaranteed, and are subject to change or cancellation. Blanco America assumes no responsibility for use of superseded or voided specifications.

PRODUCT SPECIFICATION

Drop-In sink to be 1-3/4 bowl design, 33" in length and 22" in front-to-back depth. Sink to be made from 20 gauge, 304 series stainless steel, with 18/8 chrome/nickel content and satin finish. Sink to feature rear drain placement and straight bowl sides with 1-1/2" cutout corner radius. Sink to be Blanco Model 501-109, with large bowl depth of 7-1/4" and small bowl depth of 7-1/4".



MODEL 501-109

NOMINAL DIMENSIONS

MODEL	OVERALL	CUTOUT SIZE	BOWL DEPTH LEFT	BOWL DEPTH RIGHT	DRAIN DIAMETER
501-109	33 x 22	32-1/4 x 21-1/4	7-1/4	7-1/4	3-1/2

DXF cutout templates available on our web site.

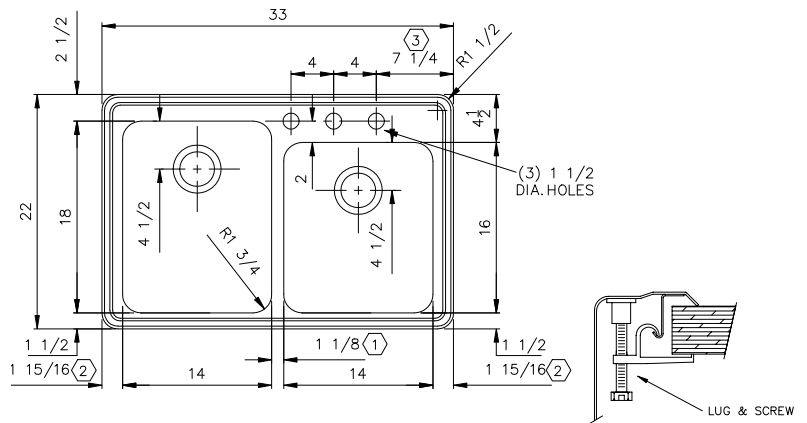

SECTION THRU FLANGE
 MAKE CUTOUT ACCURATELY 3/4" LESS IN WIDTH AND IN LENGTH THAN OVERALL DIMENSIONS. CORNERS OF CUTOUT TO BE A 1 1/2" RADIUS.

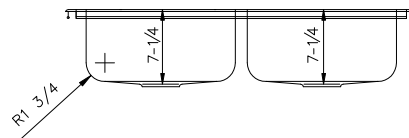

JOB INFORMATION

Job Name: _____
 Contact: _____
 Date Specified: _____
 Specifier: _____
 Contractor: _____

KNOCKOUT HOLE LOCATIONS

Pre-drilled for three faucet holes.
 No additional holes available.

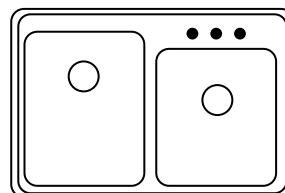

BLANCO AMERICA
 800.451.5782
 www.blancoamerica.com



GE Appliances

GFC325F—GE Large Capacity Continuous Feed Disposer

Disposal® Food Waste Disposer Dimensions (in inches)

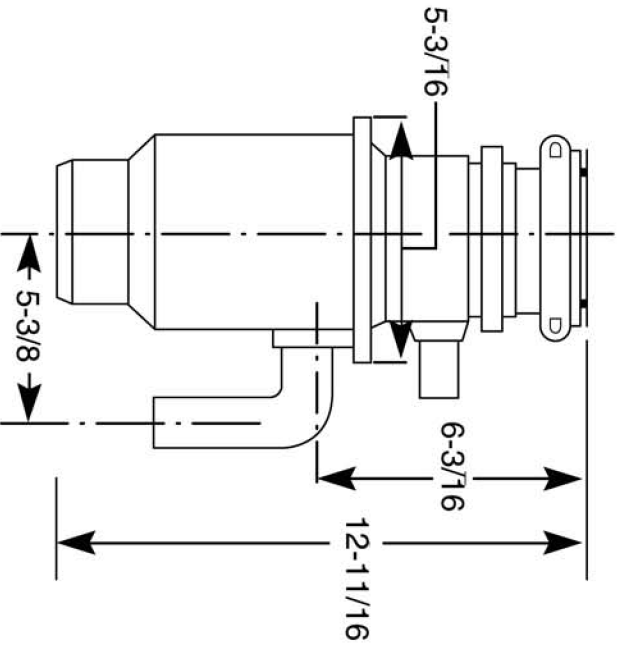

Inlet/Outlet Diameters	
Dishwasher inlet diameter (in.)	3/4
Drain outlet diameter (in.)	1-1/2

For answers to your Monogram®, GE Profile™ or GE appliance questions, visit our website at WWW.GEAppliance.com or call GE Answer Center® service, 800.626.2000.





GE Appliances

GFC325F—GE Large Capacity Continuous Feed Disposer

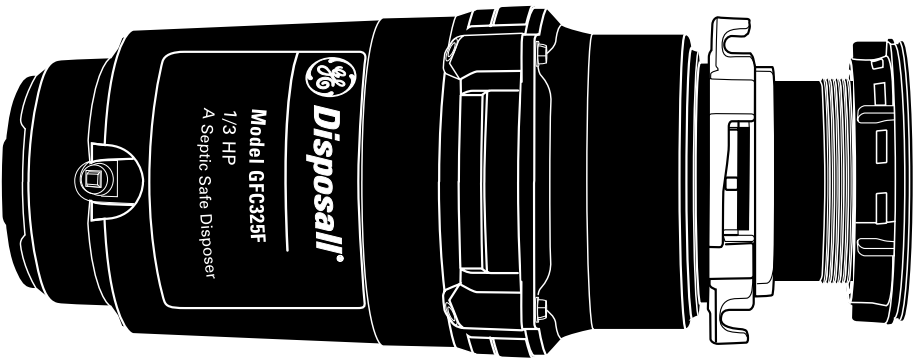

Features and Benefits

- Large Capacity Continuous Feed Disposer
- 1900 RPM Grinding Action
- 1/3 Horsepower Motor
- 2 Level Precutter
- Galvanized Steel Turntable
- Stainless Steel Jam Resistant, Dual Swivel Impellers
- Line Cord Power Connection
- Stainless Steel Sink Flange
- Dishwasher Drain Connector
- Manual Reset Overload Protector
- Wall Switch with Sink Stopper
- SplashGuard
- Cold-Rolled Carbon Steel Armature Shaft Material
- Standard Sound Insulation Package
- EZ Mount Installation
- Model GFC325F

GE® Tall Tub Built-In Dishwasher

Model# GLDA690PBB

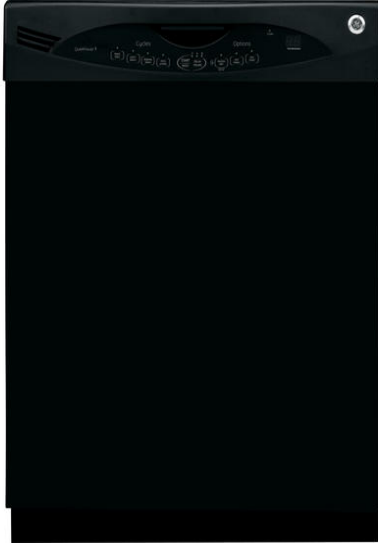

- ADA-compliant - Dishwasher design allows for simple operation and easy access
- ENERGY STAR® Qualified - Meets or exceeds federal guidelines for energy efficiency for year-round energy and money savings
- Bright annealed stainless steel interior - Lustrous interior looks great and stands up to stains
- 9 Electronic Touchpads - Provide a smooth, easy-to-use, easy-to-clean surface
- 2-digit countdown display with 2/4/8-hour Delay Start - Electronic display counts down to delayed start time
- Electronic controls with 4 cycles/4 options - Modern controls make it easy to program the dishwasher
- Nylon racks - Durable racks are designed to resist rust and secure dishes
- Two utility shelves in tiered upper rack with StemSafe™ - Long-lasting shelves help organize racks and protect delicate stemware
- Heated Dry option - Adds warm air to speed up the drying process
- Pots and Pans cycle - Tough food stains are scrubbed and scoured clean with ease
- Deluxe lower rack - Curved, single loop tines allow for easy loading and unloading

FEATURES

Rack Features	2 Plastic Utility Shelves with StemSafe Deluxe Silverware Basket
Water Filtration System	100% Triple Water
Latch	Squeeze
Exterior Style	Traditional
Tub and Door Liner	Stainless Steel
Dishwasher Cycles	Normal Wash Rinse Only Light Wash Pots & Pans
Dishwasher Drying Features	Multi-Wattage Calrod Heater
Leveling System	Leveling Screws
Dishwasher Control Features	2 Digit Display Cycle Countdown 1 "Clean" Cycle Progress Indicator Start / Cancel / Reset Pad Last Cycle Memory Lock Pad
Wash System	5-Level
Lower Rack	Deluxe Towerless
Number of Options	6
Number of Cycles	4
Upper Rack	Tiered
Number of Place Settings	Up to 12
Tub Type	Tall Tub
Dispenser	Rinse Aid with Indicator and Adjustment
Wash System Features	Dual Pumps and Motors Automatic Temperature Control Automatic Temperature Sensing Drain Hose
Wash Arms	2 with Upper Nozzle Lower Middle Upper
Control Type	Electronic 9 Touchpads Front Controls
Dishwasher Options	Delay Start 2/4/8 Hr. HotStart™ Heated Dry On/Off Hot Wash

Have more questions? Please contact 1-800-626-2005

GE® Tall Tub Built-In Dishwasher

Model# GLDA690PBB

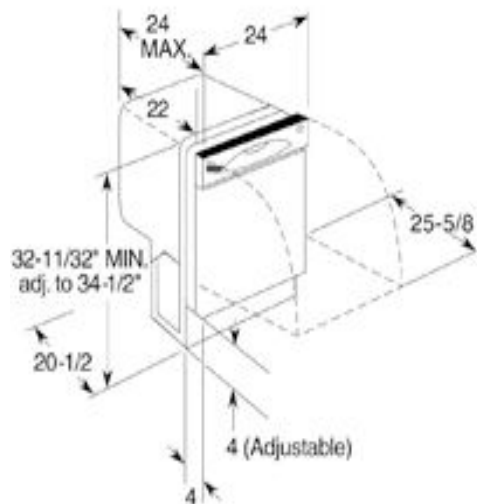

APPROXIMATE DIMENSIONS (HxDxW)

- 32 11/32 in x 24 in x 24 in

WARRANTY

- Warranty Notes - For models produced on or after January 1, 2006
See written warranty for full details
- Labor Warranty - Limited 1-year entire appliance
- Parts Warranty - Limited 1-year entire appliance

Have more questions? Please contact 1-800-626-2005

GLDA690PWW/GLDA690PBB/GLDA696PSS GE® Tall Tub Built-In Dishwasher

Dimensions and Installation Information (in inches)

Electrical Rating

Voltage AC.....	120
Hertz.....	60
Total connected load amperage.....	9.1
Calrod® heater watts max.....	875

For use on adequately wired 120-volt, 15-amp circuit having 2-wire service with a separate ground wire. This appliance must be grounded for safe operation.

Note: The rough cabinet opening must be at least 24" deep, 24" wide and approximately 34-1/2" high from floor to underside of the countertop. Dishwasher must not be installed more than 10 feet from sink for proper drainage. All plumbing and electrical work must be in accordance with local codes. The power cord and connections must comply with the National Electrical Code Section 422 and/or local codes and ordinances. The cord must be no longer than 6 ft. from the junction box to the receptacle.

Installation Information: Before installing, consult installation instructions packed with product for current dimensional data.

For answers to your Monogram,® GE Profile™ or GE® appliance questions, visit our website at ge.com or call GE Answer Center® service, 800.626.2000.

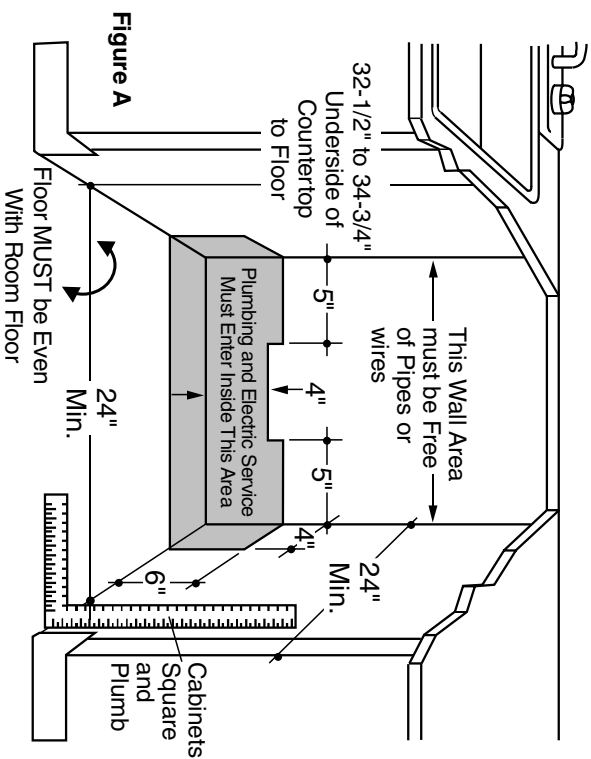
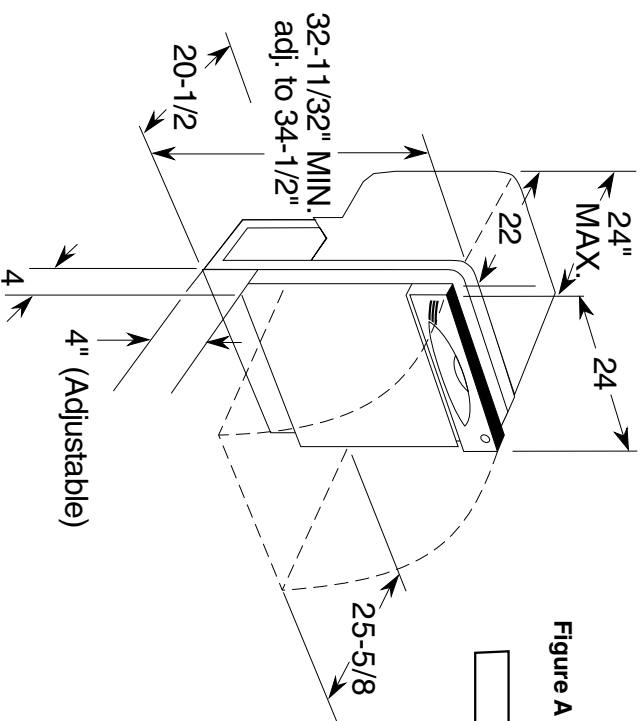

imagination at work



Listed by
Underwriters
Laboratories



As an ENERGY STAR® partner, GE has determined that this product meets the ENERGY STAR guidelines for energy efficiency.

GLDA690PWW/GLDA690PBB/GLDA696PSS GE® Tall Tub Built-In Dishwasher

Features and Benefits

- ADA-Compliant for Height - Designed for easy access and operation
- Bright Annealed Stainless Steel Interior - A lustrous finish and lasting beauty that resists stains and corrosion
- 9 Electronic Touchpads - Provide a smooth, easy-to-use, easy-to-clean surface
- 2 Digit Countdown Display with 2/4/8-Hour Delay Start - Signals remaining cycle time, makes it easier than ever to wash dishes at any hour, taking advantage of reduced energy rates or washing dishes even when the family is asleep
- Electronic Controls with 4 Cycles/4 Options - Make it easy to select a wide range of wash cycles
- Two Utility Shelves in Tiered Nylon Upper Rack with 1 StemSafe™ - Adjust easily, provide room to stack items and a secure place to wash delicate stemware
- Deluxe Nylon Lower Rack - Curved tines accommodate stoneware, large plates or broiler pans
- Pots and Pans Cycle - Scours off baked-on food with a wall of water
- Heated Dry Option - Circulates warm air to quickly and gently dry dishes
- Model GLDA696PSS - Stainless steel (shown)
- Model GLDA696PWW - White on white
- Model GLDA696MBB - Black on black

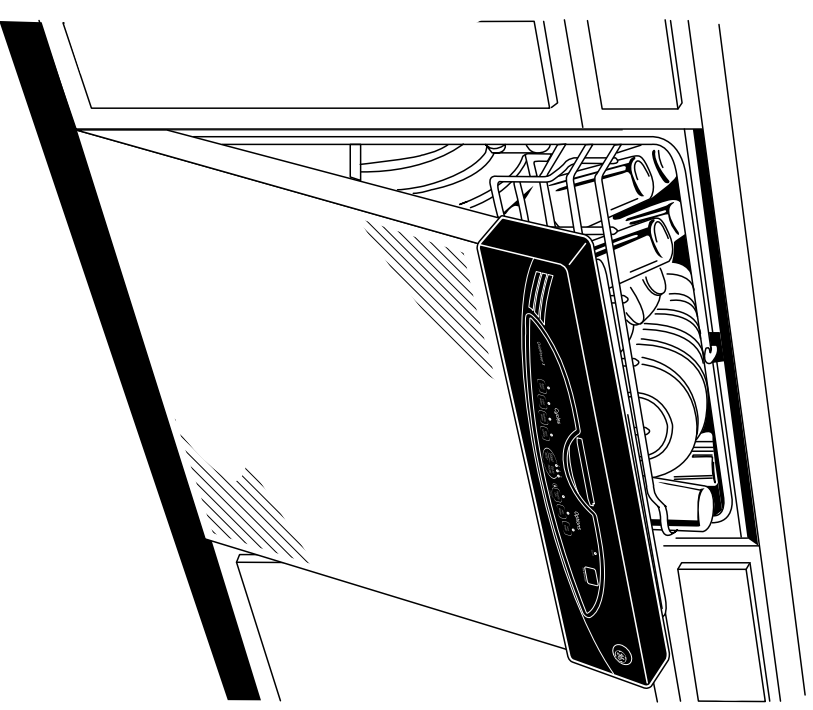

imagination at work



As an ENERGY STAR® partner, GE has determined that this product meets the ENERGY STAR guidelines for energy efficiency.

4-Slice Toaster

T4030

Double your toasting options! With dual independent controls, you can toast two slices of bread or two waffles at the same time to suit individual preference. Select the Bagel Mode to toast your favorite bagels golden brown on the cut side and deliciously warm on the outside.

Convenience at Your Fingertips

- Function Indicator Light
- Self-Adjusting Guides
- Extra-Wide Slots
- Cord Wrap
- Extra-Lift

Easy-to-Use Toast Functions

- Bagel, Frozen and Cancel
- Toast Shade Selectors

Cleans Easily

- 2 Removable Crumb Trays



Please Read and Save this Use and Care Book

Por favor lea este instructivo antes de usar el producto

Veillez lire et conserver ce guide d'entretien et d'utilisation



Toast-R-OvenTM

Countertop Oven/Broiler
Horno-asador de mostrador
Four-rôtissoire de comptoir



USA/Canada
Mexico

1-800-231-9786
01-800-714-2503

www.blackanddecker.com

Models
Modelos
Modèles

- TRO700B
- TRO700W
- TRO701T

Accessories/Parts (USA/Canada)
Accesorios/Partes (EE.UU./Canadá)
Accessoires/Pièces (É.-U./Canada)
1-800-738-0245

Product may vary slightly from what is illustrated.

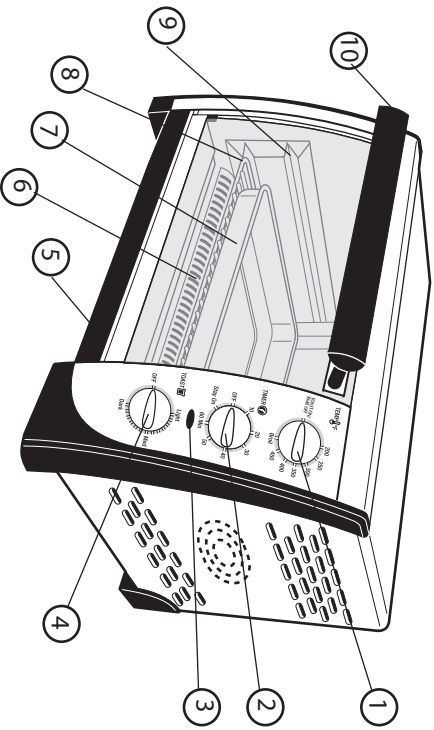

- A
1. Bake/Broil temperature selector (Part #TRO700-04)
 2. 60-minute bake timer
 3. On indicator light
 4. Toast shade selector
 - + 5. Slide-out crumb tray (Part #TRO700-02)
 - + 6. Slide rack/Broil rack (Part #TRO700-01)
 - + 7. Bake pan/drip tray (Part #TRO700-04)
 8. Slide rack support rails
 9. Rack slot
 10. Door handle
 - + Consumer replaceable/removables parts

CONTROL PANEL

1. Bake/Broil temperature selector
2. 60-minute timer with Stay On
3. On indicator light
4. Toast shade selector

Important: When using the **TIMER** function, always turn the dial past 20 and then turn back or forward to desired setting.

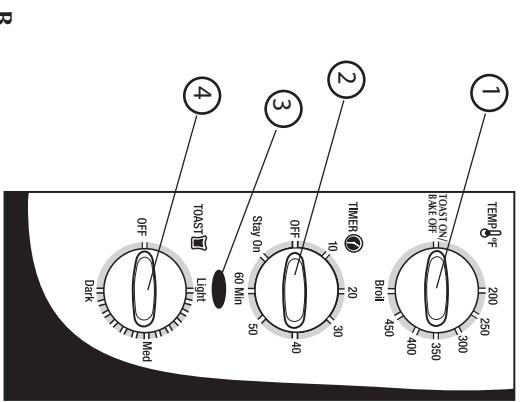

How to Use

This product is for household use only.

	<p>CAUTION</p> <p>THIS OVEN GETS HOT WHEN IN USE. ALWAYS USE OVEN MITTS OR POT HOLDERS WHEN TOUCHING ANY OUTER OR INNER SURFACE OF THE OVEN.</p>
--	--

GETTING STARTED

- Remove packing materials and any stickers.
- Remove the slide rack/broil rack and bake pan/drip tray from oven.
- Wash in sudsy water, rinse and dry with a cloth or paper towel.
- Replace slide rack/broil rack in oven.
- Select a location for the unit. Do not place unit under cabinets or too close to the wall to allow heat to flow without damaging counter space.

OVERVIEW OF FUNCTIONS To Bake

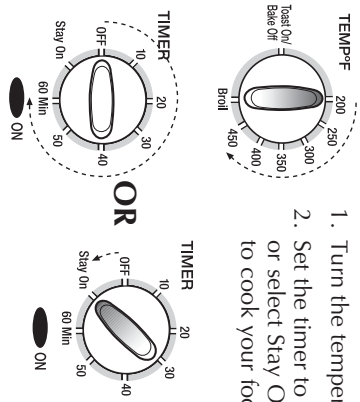

1. Turn the temperature selector to desired temperature.
2. Set the timer to desired baking time including preheat time or select Stay On, if you want to control cooking time or need to cook your food longer than 60 minutes.

Important: When using the **TIMER** function, always turn the dial past 20 and then turn back or forward to desired setting.



Summit Appliances

[Home](#)
[About Us](#)
[Product Catalog](#)
[Options & Accessories](#)
[Service and Support](#)
[Product and Installation](#)
[Downloads](#)
[Order Status](#)
[Career Opportunities](#)
[Dealer News](#)
[Site Map](#)
[Contact Us](#)

Search for a Product

[Go](#)

Search by Dimension

[Go](#)

Quick Links to Popular Models

[Go](#)

ALB753BCSS



For a larger image, click on the photo above

SUMMIT PROFESSIONAL ALB751SSH is a 32 inch high all-refrigerator with wrapped stainless steel door and horizontal stainless steel towel bar for lower ADA counters or assisted living facilities. It has SUMMIT's hidden evaporator (behind the rear wall) that offers some of the largest shelves in the industry. It is 24 inches wide with fully automatic defrost and featured with reversible doors, adjustable shelves, interior light, and a crisper. This model is made for built-in (under-counter) use.

This model is available in SUMMIT **COLORS**. Match, contrast, or accent your cabinets by calling attention to the refrigerator - have it blend in with its surroundings or add fun to a special room. [Click here](#) to see the available colors.

Capacity	5.5 c.f.
Dimensions	32" x 23 5/8" x 23 1/2" (H x W x D)
Defrost Type	Automatic
Body Color	Stainless Steel
Door Color	Stainless Steel
Door Swing	RHD or LHD
Shipping Weight	100 lbs.
UPC Code	761101012056 / 761101012063 (LHD)
Features	<ul style="list-style-type: none"> ● All-refrigerator ● Fully automatic defrost ● Interior light ● 32 inch height for lower ADA counters ● Wrapped stainless steel cabinet and stainless steel door with pro-style handle ● Energy efficient design ● Large adjustable shelves ● 100% CFC free ● U.L. Approved ● 115 V ● 60 cycle

	<ul style="list-style-type: none">● 1 year parts and labor plus 5 year limited warranty● ADA compliant - fits lower height cabinets● 4 level legs
Other Finishes Available	White, stainless steel
Documents	Use and Care Guide (PDF)
List Price	\$2300
MSRP	\$1610

Summit Appliances Division, Felix Storch, Inc. • 770 Garrison Ave • Bronx, NY 10474
Phone: 718-893-3900 • Fax: 718-842-3093 • Email: info@summitappliance.com

GSHS9NGY

GE® ENERGY STAR® 29.1 Cu. Ft. Side-By-Side Refrigerator with Integrated Dispenser

Dimensions and Installation Information (in inches)

Overall Dimensions		
Height to top of hinge (in.) A		69-5/8
Height to top of case (in.) B		68-3/4
Case depth without door (in.) C [†]		28
Case depth less door handle (in.) D [†]		33-5/8
Case depth with door handle (in.) E [†]		36-1/8
Depth with fresh food door open 90° (in.) F [†]		50-1/16
Width (in.) G		35-3/4
Width with door open 90° inc. door handle (in.) H		45-1/2
Air Clearances		
Each side (in.)		1/8
Top (in.)		1
Back (in.)		1

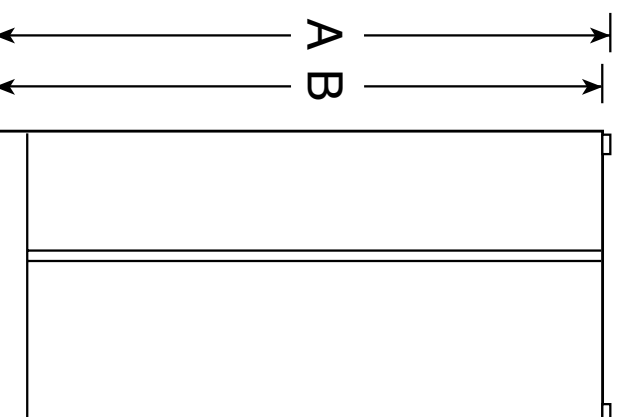

Front View

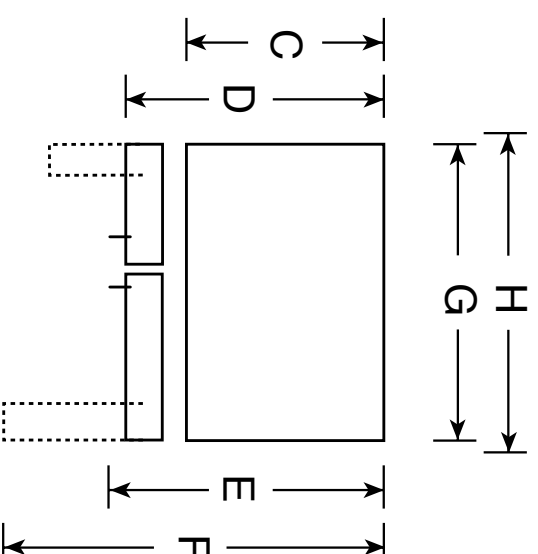

Top View

[†]Water hook-up fits in back air clearance when calculating installation depth.

If installed against a wall, allow clearance of 14-3/16" on freezer side to remove bin.

Clearance required to remove fresh food full-size pan without disassembling is 18-15/16".

Allow additional space for any necessary leveling adjustments.

For answers to your Monogram,® GE Profile™ or GE® appliance questions, visit our website at ge.com or call GE Answer Center® service, 800.626.2000.



imagination at work



Listed by
Underwriters
Laboratories



As an ENERGY STAR® partner, GE has determined that this product meets the ENERGY STAR guidelines for energy efficiency.

GSHS9NGY

GE® ENERGY STAR® 29.1 Cu. Ft. Side-By-Side Refrigerator with Integrated Dispenser

Features and Benefits

- Stainless steel exterior - Stainless steel adds elegance to any kitchen décor
- Integrated dispenser with LED lighting and UltraFlow64 - This bright dispenser pours up to 64 ounces of water per minute
- Quick Ice™ setting - Speed up your icemaker to keep up with your life
- TurboCool™ setting - Restores proper temperature to the refrigerator after frequent door openings
- Integrated Ice™ system - Designed to give you more room to store your favorite frozen foods
- Integrated shelf support system - Strong shelf supports add a contemporary look
- Adjustable ClearLook™ door bins - Store gallon containers with ease in the door and free up valuable shelf space
- In-the-door beverage rack - Beverages are easy to grab when you're on the go
- Adjustable, slide-out spillproof glass shelves - Adjustable shelves are designed to make clean up quick and easy
- GE water filtration - one year filter - An indicator light lets you enjoy filtered water with added confidence
- FrostGuard™ technology - Controlled defrosting keeps frozen foods from feeling the burn
- Premium quiet design - Enjoy the sound of GE's most advanced sound control system
- Model GSHS9NGYSS - Stainless steel
- Model GSHF9NGYWW - White
- Model GSHF9NGYBB - Black

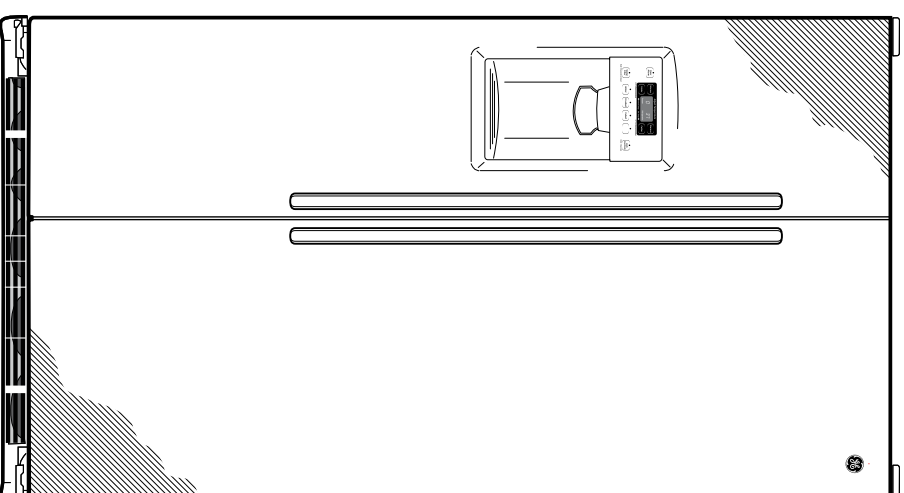

imagination at work



As an ENERGY STAR® partner, GE has determined that this product meets the ENERGY STAR guidelines for energy efficiency.

SHARP.

print



LC-26DV27UT | Televisions

Sharp's 26" Class (26" Diagonal) LC-26DV27UT LCD TV provides a convenient built-in DVD television solution with a distinctive design. The LC-26DV27UT features a side-loading progressive scan DVD player, a high-performance LCD panel for high brightness, a high contrast ratio, low-reflection glare protection and wide viewing angles.

Features

- **16:9 Aspect Ratio (1366 x 768) LCD Panel**
displays 16:9 widescreen programs in their native aspect ratio without the need for scaling or other video processing.
- **Built-in Side-Loading Progressive Scan DVD Player**
is the ultimate in convenience!
- **Built-in ATSC/QAM/NTSC Tuners**
for DTV and analog TV viewing.
- **High Brightness**
Sharp LCD TVs are very bright, so you can put them virtually anywhere – even near windows, doors or other light sources – and their picture is still vivid.
- **Dual HDMI™ Input**
for convenient connection to digital devices.
- **High Contrast Ratio**
proves incredible images whether you're watching dark or bright scenes!
- **PC Input**
easily turns your TV into a PC monitor.

Specifications

- **Screen Size** 26" Class (26" Diagonal)
- **Panel Type** Active Matrix (a-si TFT) LCD
- **Pixel Resolution** 1366 x 768
- **Tuning System** ATSC/QAM/NTSC
- **DVD Player** Built-in Progressive Scan
- **Brightness** 450 cd/m²
- **Viewing Angle** 160° H x 150° V
- **Lamp Life** 50,000 hours¹
- **Audio System** 5 watt x 2 = 10 watts total
- **Contrast Ratio** Enhanced Picture Contrast Technology
- **Response Time** 5ms
- **Aspect Ratio** 16:9
- **HDMI™ Input** 2
- **PC Input** 1
- **Component Input** Y/Pr/Pb x 1
- **S-Video Input** 4-pin DIN x 1
- **Composite Video Input (A/V)** RCA x 2
- **Audio Input** RCA L/R x 2, 3.5mm Stereo Jack x 1

■ Audio Output	Headphone Jack 3.5mm, Digital Audio Output x 1
■ Power Consumption	70w (0.7W Standby)
■ Power Source	120V @ 60 Hz
■ Limited Warranty	1-year parts and labor from date of purchase
■ Cabinet Color	Black
■ TV Dimensions (w x h x d)	TV and Stand: 26-1/32" x 20" x 9-9/16" TV Only: 26-1/32" x 18-13/64" x 3-61/64"
■ TV Weight	TV and Stand: 21.4 lbs. TV Only: 18.1 lbs.
■ UPC	074000372146

¹The typical period of time after which the lamp's power output will have decreased by about half, given that the AQUOS LCD TV is used continuously in a 77 degree F room under standard lighting and brightness conditions.

HDMI, the HDMI logo and High Definition Multimedia Interface are trademarks or registered trademarks of HDMI Licensing, LLC.

Product specifications and design are subject to change without notice.

© 2009 Sharp Electronics Corp.
Sharp and AQUOS are registered trademarks of Sharp Corporation.
All other marks are the property of their respective holders.

[sitemap](#) [legal](#) [privacy](#)



Order Online or call 1.877.674.2832

[Need Accessories or Supplies?](#)

[Customer Support](#)

[FAQs](#)

[Order Status](#)



Shopping Cart

Top Accessories

- [Air Conditioner Kits](#)
- [Other Accessories](#)
- [Brackets](#)
- [Cables](#)
- [Remote Control Products](#)
- [Cookware](#)
- [Cook Books](#)

Find Accessories

by Main Categories

- [Air Conditioners](#)
- [Air Purifiers](#)
- [Audio Products](#)
- [Camcorders](#)
- [Commercial Ovens](#)
- [Digital Cameras](#)
- [DVD Players/Recorders](#)
- [Front Projectors](#)
- [Vacuums](#)
- [Microwave Ovens](#)
- [Commercial Video Products](#)
- [LCD TVs](#)
- [LCD Monitors](#)
- [Personal Computers](#)
- [Ranges](#)
- [Rear Projectors](#)
- [Small Appliances](#)
- [Traditional CRT TVs](#)
- [TV/VCR Combinations](#)
- [VCRs](#)
- [Calculator](#)
- [Copier](#)
- [Fax](#)
- [Registers](#)

Accessories & Supplies : Search Results



Item No.	Item Description	Compatibility	Availability	Price	Qty.
ANLCGWF	Flat Wall Mount Bracket	View Models	In Stock	Your Price: \$125.00	<input type="button" value="add to cart"/> 1

Store Help

- ▶ [Order Status](#)
- ▶ [FAQs](#)
- ▶ [Privacy Policy](#)

- ▶ [Terms & Conditions](#)
- ▶ [Return Policy](#)
- ▶ [Shipping & Delivery](#)

Help me Choose

- ▶ [Protection Plan Advisor](#)
- ▶ [Home Delivery Advisor](#)
- ▶ [LC-TV Mounts Advisor](#)

- ▶ [Join Mailing List](#)
- ▶ [Current Promotions](#)
- ▶ [Contact Us](#)



[Sharp Direct Terms & Conditions](#) [Sharp Direct Privacy Policy](#)

© 2008 Sharp Electronics Corp.

Sharp and AQUOS are registered trademarks of Sharp Corporation.
 iPod is a trademark of Apple Inc. registered in the U.S. and other countries
 All other marks are the property of their respective holders.

Sharp Direct offers a wide selection of genuine Sharp accessories and supplies for all your Sharp office, home, entertainment, and appliance products. Search Sharp Direct to locate quality Sharp accessories such as brackets, cables, remote controls, cookbooks, and more. Sharp Direct includes a wide selection of official Sharp supplies such as ink cartridges, toner, vacuum bags, and filters that have been thoroughly tested to fit and work with your Sharp product. Shop Sharp Direct and buy genuine Sharp accessories and supplies that have been designed and approved specifically to ensure proper functionality of your Sharp product.



FACILITY
PROGRAMMING
AND CONSULTING

Frost Bank Tower, Suite 1100
100 West Houston Street
San Antonio, Texas 78205
Phone: 210/228-9600
Fax: 210/228-9697
facilityprogramming.com

Architectural Programming
Laboratory Planning
Healthcare Planning
Strategic Facilities Planning
Needs Assessment
Space Utilization Analysis

SAN ANTONIO | HOUSTON

